

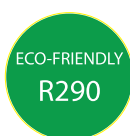

eptarefrigeration

# ASIA 115

GLASS DOOR FREEZER



## FEATURES INCLUDE:

White internal  
RAL 9007 grey external  
High efficiency fan motors  
5 levels height adjustable shelves

Internal LED mullion lighting  
Electronic temperature control  
Condensation removal via hot gas discharge

**BAKER**

REFRIGERATION

Visit our website [www.ajbaker.com.au](http://www.ajbaker.com.au) or email us at [email@ajbaker.com.au](mailto:email@ajbaker.com.au)

Image used for illustration only.

# ASIA 115

GLASS DOOR FREEZER

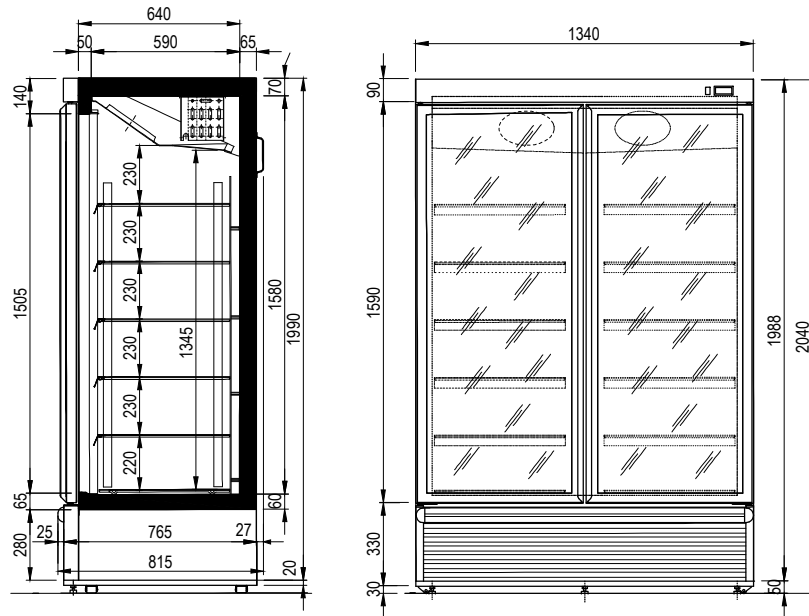

| ASIA 115                    | 115                  |
|-----------------------------|----------------------|
| * Operating Temp (°C)       | -25/-15              |
| Refrigeration               | Ventilated/R290      |
| Defrost                     | Automatic            |
| Power Supply                | 230V/1Ph/10 Amp plug |
| Operating Current (Amp)     | 4.8                  |
| Nominal power (W)           | 1120                 |
| Energy Consumption (kW/24h) | 18.4                 |
| Glass Doors                 | 2                    |
| Total Capacity (Itr)        | 824                  |
| Length (mm)                 | 1340                 |
| Height excl. legs (mm)      | 2040                 |
| Height incl. legs (mm)      | 2140                 |
| Depth (mm)                  | 816                  |
| Weight with packaging (kg)  | 330                  |
| Weight w/o Packaging (kg)   | 281                  |

\* Climate class 3 (25°C 60%R/H)